

Steel types

Technical data sheet

- Font engraving similar to Arial (DIN 1451, medium-spaced lettering)
- Nickel-plated design
- Single or complete in type box available
- On stock available engravings: A – Z; 0 – 9; . (dot); , (comma); - (dash); / (slash)



Single steel types

Application Area

Steel types were used to mark or stamp fixed text. They can be combined in a type box or in special numbering heads. In BORRIES hand stamping tools steel types were especially used for control stamping and marking.

Steel types in a type box



Option

- Small characters, special characters as well as bigger font heights on request

On stock available sizes

SH = font height	L = stamp length	B = stamp width	stamp height	original marking height
1.0	1.5	4.0		123ABC
1.5	1.5	4.0		123ABC
2.0	2.0	4.0		123ABC
2.5	2.5	6.0		123ABC
3.0	3.0	6.0	19 mm at any sizes	123ABC
4.0	4.0	8.0		123ABC
5.0	5.0	8.0		123ABC

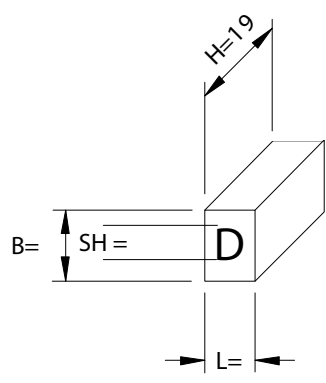

all dimensions in mm

Engraved/ block stamp

- Single stamps or multidigit engravings in medium-spaced, semi closed-spaced and closed-spaced lettering
- Engraving design: spiky, blunt, plane or perforated
- Special characters, logos etc.

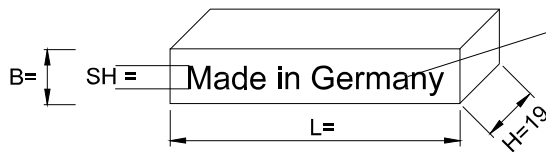

engraving is in-verse on the stamp



Option

- Dimension, form and engraving at individual customer requirements

Spiky engraving

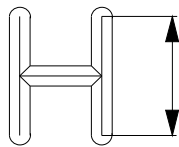
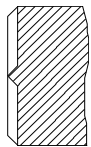

SH= Schrifthöhe

Plane engraving

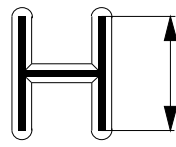
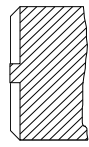

SH= Schrifthöhe

Perforated engraving

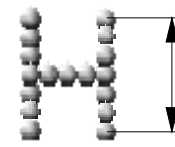

SH= Schrifthöhe

also available as brazen stamp

Pin stamps

- Dimension, form and engraving at individual customer requirements
- Used in Borries hand stamping tools (BM 10, BM 21, BM 25) and stamping machines (BM 11/12, BM 18/21, BM 30/35)



Application area

Pin stamps were used in Borries hand stamping tools and stamping machines.

Option

- Special engravings on request

Technical details are subject to change.